

Vacant Space Inspection Report

Shopping Center:	TEL-TWELVE	Date:	7-26-11
Space Number:	C-5	Square Footage:	2,544
Space Address:	28632 TELEGRAPH ROAD	Frontage:	29'6"

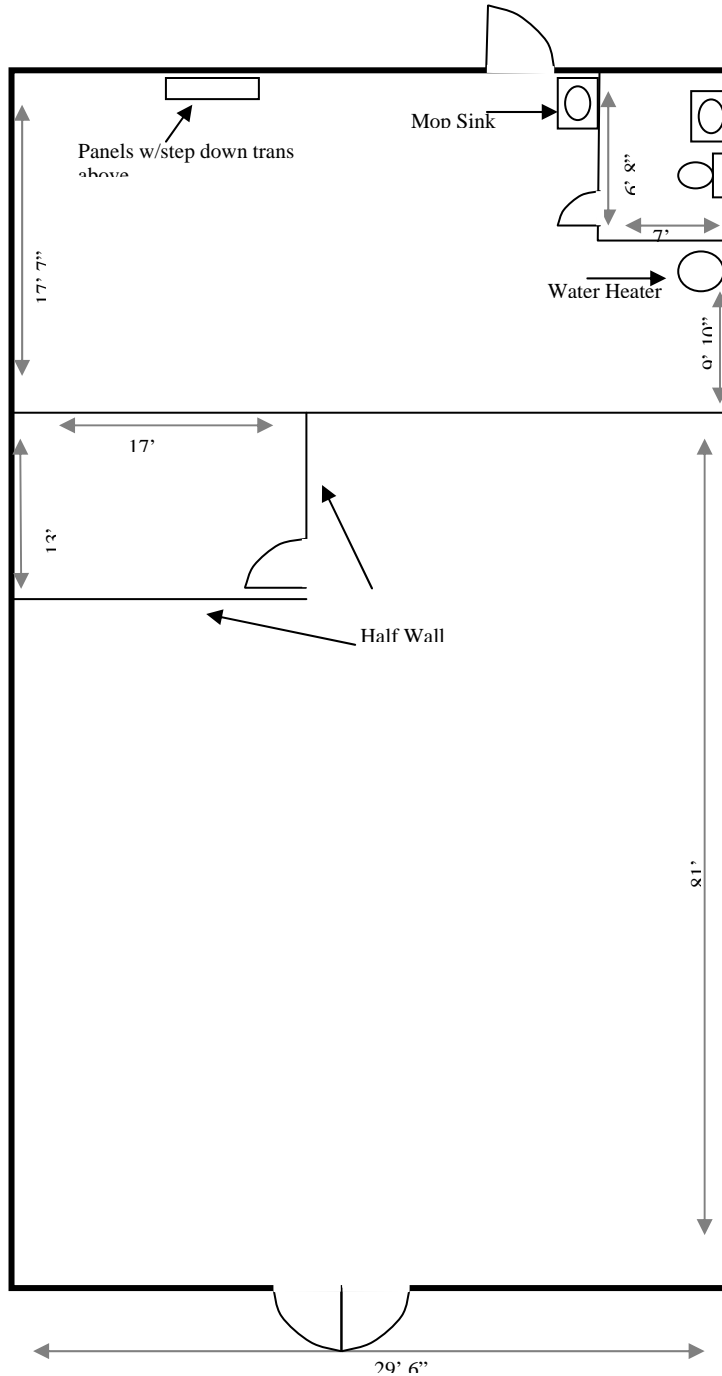

This drawing is illustrative and for informational purposes only. The layout may not be final or to scale and is subject to change without notice. If you are interested in leasing space or affected by the space drawn in any way, you are urged to verify the layout, sizes and other information presented.

Vacant Space Inspection Report

Shopping Center:	TEL-TWELVE	Date:	7-26-11
Space Number:	C-5	Square Footage:	2,544
Space Address:	28632 TELEGRAPH ROAD	Frontage:	29'6"

PHOTOS:

