

Dates:  
 FEB. 6, 2009  
 MAR. 17, 2009  
 MAY 19, 2009  
 OCT. 12, 2009  
 DEC. 15, 2009  
 MARCH 10, 2010  
 APRIL 13, 2010  
 JULY 13, 2010  
 AUGUST 15, 2010  
 OCT. 15, 2010  
 NOV. 12, 2010  
 DEC. 18, 2010  
 JANUARY 12, 2011  
 APRIL 21, 2011  
 MAY 10, 2011  
 SEPT. 13, 2011  
 OCTOBER 11, 2011  
 APRIL 24, 2012

Owner  
 RAMCO-GERSHENSON INC.  
 31500 Northwestern Hwy  
 Farmington Hills, MI 48334

Subject  
 SITE/LEASE PLAN

Project  
 CHESTER SPRINGS SHOPPING CENTER  
 CHESTER, NEW JERSEY

DISCLAIMER  
 THESE DRAWINGS ARE PREPARED BY THE ENGINEER AND ARCHITECT FOR THE PROJECT DESCRIBED HEREIN. THE USER SHALL BE RESPONSIBLE FOR OBTAINING ALL NECESSARY PERMITS AND FOR VERIFYING THE ACCURACY OF ALL INFORMATION AND DATA PROVIDED TO THE ENGINEER AND ARCHITECT. THE ENGINEER AND ARCHITECT SHALL NOT BE RESPONSIBLE FOR ANY ERRORS OR OMISSIONS IN THESE DRAWINGS.

RAMCO GERSHENSON INCORPORATED  
 31500 Northwestern Hwy  
 Farmington Hills, MI 48334  
 TEL: 248.463.1000  
 FAX: 248.463.1001

Job Number  
 2723-98  
 Sheet Number  
 AVAILABILITY - 17

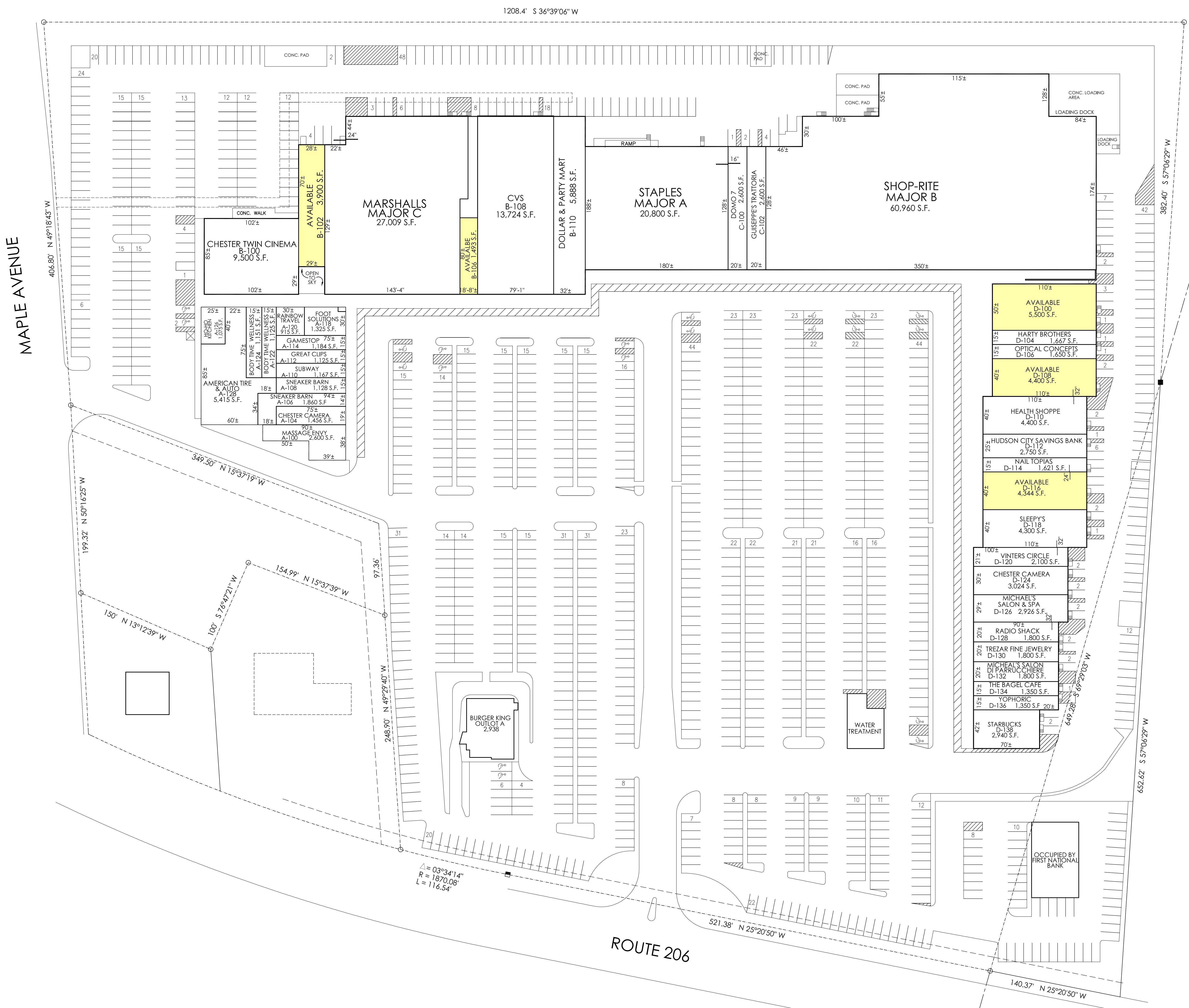

SPACE:	AREA	TENANT:
MAJOR A	20,800 S.F.	STAPLES
MAJOR B	60,960 S.F.	SHOP-RITE
MAJOR C	27,009 S.F.	MARSHALLS
OL-A	2,938 S.F.	BURGER KING
A-100	2,600 S.F.	MESSAGE ENVY
A-104	1,456 S.F.	CHESTER CAMERA
A-108	2,988 S.F.	SNEAKER BARN
A-110	1,167 S.F.	SUBWAY
A-112	1,125 S.F.	GREAT CLIPS
A-114	1,184 S.F.	GAMESTOP
A-118	1,325 S.F.	FOOT SOLUTIONS
A-120	915 S.F.	RAINBOW TRAVEL
A-122	1,125 S.F.	AVAILABLE
A-124	1,151 S.F.	AVAILABLE
A-126	1,075 S.F.	HO-HO KITCHEN
A-128	5,415 S.F.	AMERICAN TIRE & AUTO
B-100	9,500 S.F.	CHESTER TWIN CINEMA
B-102	3,900 S.F.	AVAILABLE
B-106	1,493 S.F.	AVAILABLE
B-108	13,724 S.F.	CVS
B-110	5,888 S.F.	AVAILABLE
C-100	2,600 S.F.	DOMO 7
C-102	2,600 S.F.	GIUSEPPE'S TRATTORIA
D-100	5,500 S.F.	AVAILABLE
D-104	1,667 S.F.	HARTY BROTHERS
D-106	1,650 S.F.	OPTICAL CONCEPTS
D-108	4,400 S.F.	AVAILABLE
D-110	4,400 S.F.	HEALTH SHOPPE
D-112	2,750 S.F.	HUDSON CITY SAVINGS BANK
D-114	1,621 S.F.	NAIL TOPIAS
D-116	4,344 S.F.	AVAILABLE
D-118	4,300 S.F.	SLEEPY'S
D-120	2,100 S.F.	VINTERS CIRCLE
D-124	3,024 S.F.	CHESTER CAMERA
D-126	2,926 S.F.	MICHAEL'S SALON & SPA
D-128	1,800 S.F.	RADIO SHACK
D-130	1,800 S.F.	TREZAR FINE JEWELRY
D-132	1,800 S.F.	MICHAEL'S SALON DI PARRUCCHIERE
D-134	1,350 S.F.	THE BAGEL CAFE
D-136	1,350 S.F.	YOPHORIC
D-138	2,940 S.F.	STARBUCKS COFFEE
TOTALS		
MAJOR A	20,800 S.F.	
MAJOR B	60,960 S.F.	
MAJOR C	27,009 S.F.	
OL-A	2,938 S.F.	
RETAIL A	21,526 S.F.	
RETAIL B	34,505 S.F.	
RETAIL C	5,200 S.F.	
RETAIL D	49,722 S.F.	
TOTAL	222,660 S.F.	
PARKING PROVIDED	1,074 STALLS	
PARKING RATIO	4.82/1000	

AVAILABLE  
 LEASED

LEASE/SITE PLAN  
 SCALE: 1" = 50'-0"

MAPLE AVENUE

ROUTE 206

