

Vacant Space Inspection Report

Shopping Center:	Horizon Village	Date:	8-9-11
Space Number:	B-120	Square Footage:	1,300
Space Address:	2855 Lawrenceville-Suwanee Rd.	Frontage:	19' 6"

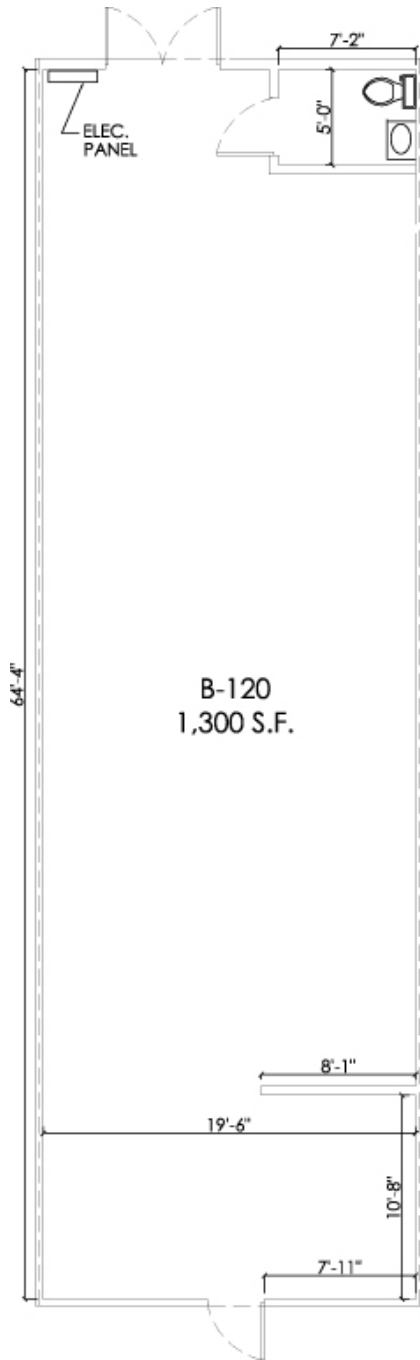

SPACE PLAN
 SCALE: N.T.S.



DISCLAIMER

THIS DRAWING IS ILLUSTRATIVE AND FOR INFORMATION PURPOSES ONLY AND SHOULD NOT BE CONSIDERED COMPREHENSIVE. DRAWING LAYOUT, SIZES, QUANTITIES, ETC. ARE SUBJECT TO SITE VERIFICATION BY THE USER OF THIS DOCUMENT. THE LAYOUT MAY NOT BE FINAL, NOR TO SCALE AND IS SUBJECT TO CHANGE WITHOUT NOTICE. RAMCO GERSHENSON INC. IS NOT RESPONSIBLE FOR ERRORS OF OMISSIONS AND NO REPRESENTATION OR WARRANTIES ARE EXPRESSED OR IMPLIED BY THIS DRAWING.

This drawing is illustrative and for informational purposes only. The layout may not be final or to scale and is subject to change without notice. If you are interested in leasing space or affected by the space drawn in any way, you are urged to verify the layout, sizes and other information presented.

Shopping Center:	Horizon Village	Date:	8-9-11
Space Number:	B-120	Square Footage:	1,300
Space Address:	2855 Lawrenceville-Suwanee Rd.	Frontage:	19' 6"

PHOTOS:



Vacant Space Inspection Report

Shopping Center:	Horizon Village	Date:	8-9-11
Space Number:	B-120	Square Footage:	1,300
Space Address:	2855 Lawrenceville-Suwanee Rd.	Frontage:	19' 6"

