

Dates:
 FEBRUARY 6, 2009
 MAY 19, 2009
 OCTOBER 13, 2009
 APRIL 7, 2010
 JUNE 1, 2010
 FEBRUARY 10, 2011
 APRIL 21, 2011

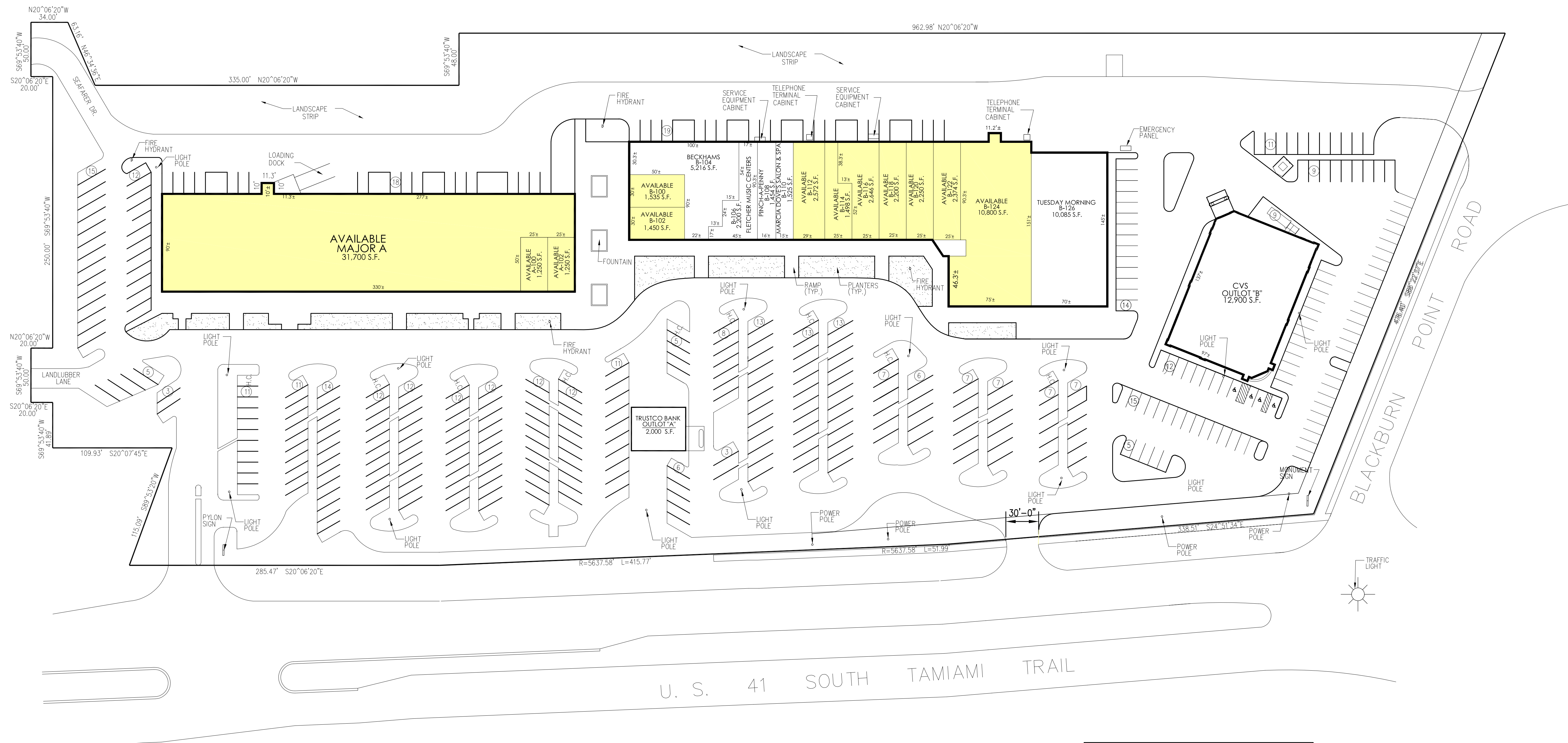

LEASE/SITE PLAN
 NORTH
 1" = 50'-0"

SPACE:	AREA	TENANT:
MAJOR A	31,700 S.F.	AVAILABLE
A-100	1,250 S.F.	AVAILABLE
A-102	1,250 S.F.	AVAILABLE
B-100	1,535 S.F.	AVAILABLE
B-102	1,450 S.F.	AVAILABLE
B-104	5,216 S.F.	BECKHAMS
B-106	2,200 S.F.	FLETCHER MUSIC CENTERS
B-108	1,454 S.F.	PINCH-A-PENNY
B-110	1,525 S.F.	MARCIA DOVE'S SALON & SPA
B-112	2,572 S.F.	AVAILABLE
B-114	1,498 S.F.	AVAILABLE
B-116	2,646 S.F.	AVAILABLE
B-118	2,200 S.F.	AVAILABLE
B-120	2,250 S.F.	AVAILABLE
B-122	2,374 S.F.	AVAILABLE
B-124	10,800 S.F.	AVAILABLE
B-126	10,085 S.F.	TUESDAY MORNING
OL-A	2,000 S.F.	TRUSTCO BANK
OL-B	12,900 S.F.	CVS
TOTAL:	96,690 S.F.	
TOTAL PARKING:	356 STALLS	
PARKING RATIO:	3.68 / 1,000 S.F.	

AVAILABLE
 EXPIRED LEASE
 LEASED

Subject
 LEASE/SITE PLAN

Project
 SOUTH BAY SHOPPING CENTER
 OSPREY, FLORIDA

DISCLAIMER
 THE DRAWING IS ILLUSTRATIVE AND FOR INFORMATION PURPOSES ONLY AND SHOULD NOT BE CONSIDERED COMPREHENSIVE. DRAWING LAYOUT, SIZES, QUANTITIES, AND DIMENSIONS ARE SUBJECT TO CHANGE WITHOUT NOTICE. THE LAYOUT MAY NOT BE FINAL NOR TO SCALE AND IS SUBJECT TO CHANGE WITHOUT NOTICE. ERRORS OF OMISSIONS AND NO REPRESENTATION OR WARRANTIES ARE EXPRESSED OR IMPLIED BY THIS DRAWING.

RAMCO GERSHENSON INCORPORATED
 3300 INTERNATIONAL AVENUE, SUITE 300
 MIAMI, FLORIDA 33133
 PHONE: 781.320.0000 FAX: 781.320.0025

Job Number
 2749-98
 Sheet Number
 AVAILABILITY-7